

Twin Bolt Lock - Bi-Fold Doors with Uno or Aria Bi-Fold Handle

ASSA ABLOY

INSTALLATION INSTRUCTIONS FOR P84130, P84131, P84216, P84217, P84225,

The global leader in
door opening solutions.

Twin Bolt Lock Overall Dimensions

Figure 1. Twin Bolt Lock Dimensions

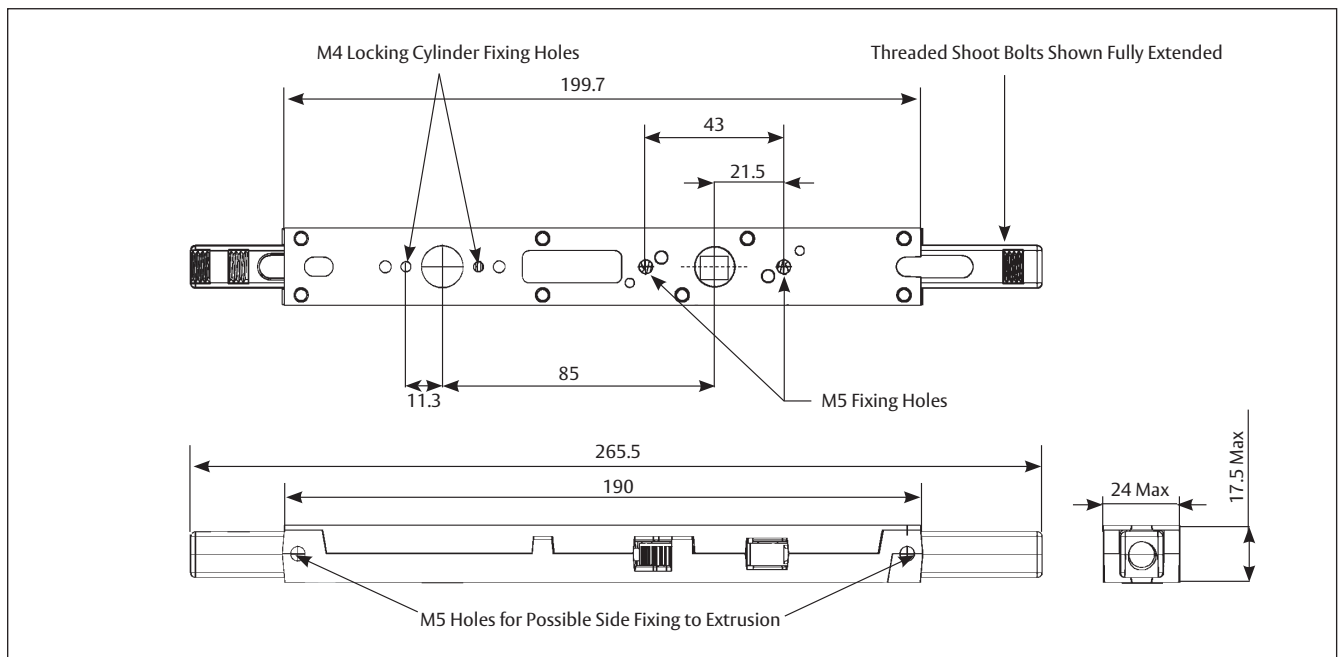

Routing Details

Routing required for use with the Uno Handle (P83001) and Aria Bi-fold handle (PB1070027). **Note:** The detail not required if the non-locking version is used.

Assembly of the lock through the side of the section (rather than the end) requires additional routing:

Figure 2. Face Routing for Uno Furniture

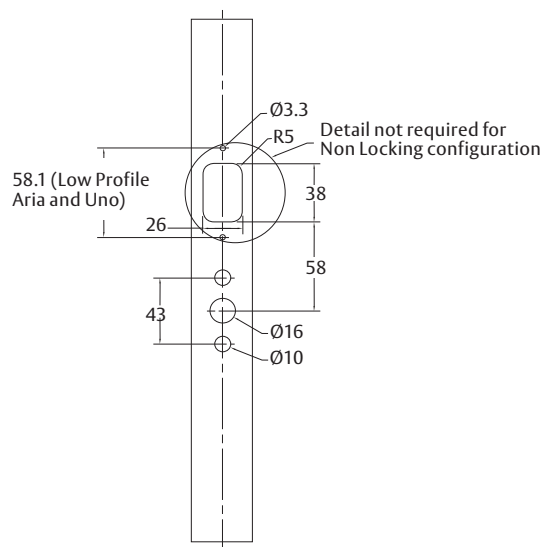
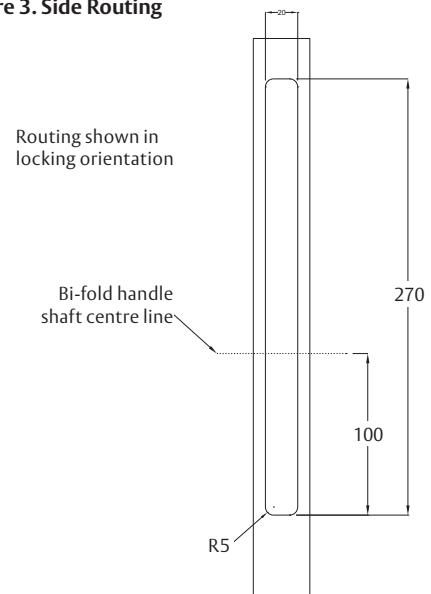

Figure 3. Side Routing



Assembly Details

1. Cut the rod to length allowing for a lock throw of 13mm.

Note: Allowance must also be made for the clearance between the door and frame, the D-tip length of 44mm and the multi-point rod threaded 14mm into the lock.

2. Press the D-tips onto the end of the multi-point rod making sure the hardened steel pin is inside the D-tip. Crimp the rods onto the D-tip to ensure a solid fit (a crimping tool – P84042 – is available for this task).
3. Screw the rods to the lock, tightening the lock nuts against the throw bolts (see warning below).
4. Select the packer to be used and clip this onto the lock body. **Note:** The packer that is not selected can be clipped onto the back of the lock to hold it for easier fixing in the section (see the screw and packer selection guide below).
5. Mount the lock assembly onto the door stile checking lock function, D-tip protrusion and D-tip orientation. Fix the handle and lock assembly using the M5 fixing screws (see the screw and packer selection guide below). **Note:** The 8mm square drive bar of the handle must protrude through the entire lock for adequate performance.
6. For Locking Version: Screw the Cyl 4 lock housing onto the lock body using the M4 fixing screw (see the screw and packer selection guide below). Assemble the lock barrel and housing cover using the retainer wafer of the lock to hold the assembly together.

Important Note:

1) The cylinder has to be installed with the key inserted. Once the cylinder is in place, the key can be withdrawn, while at the same time preventing the cylinder from backing out. This allows the retaining wafer to pop up and hold the cylinder in place. Removal of the key prior to assembly will result in the detachment of the wafers from the cylinder.

2) The cylinder should not be used externally.

7. Screw the lock escutcheon in place.

For assembly through the side of the extrusion:

Screw the multi-point rods to the lock after assembling the lock/packer and handle into the door stile.

Note on Rods: The vertical locking rods supplied cater for a maximum door height of 2300mm. For taller applications a multi-point extension kit is available which caters for a maximum door height of 3300mm, the part number for the multi-point kit is P84017, one kit required per twin bolt lock body.

Warning:

When tightening lock nut use a spanner to support the lock bolt. This will prevent any damage to the lock. See right:

Fig 4. Lock Assembly

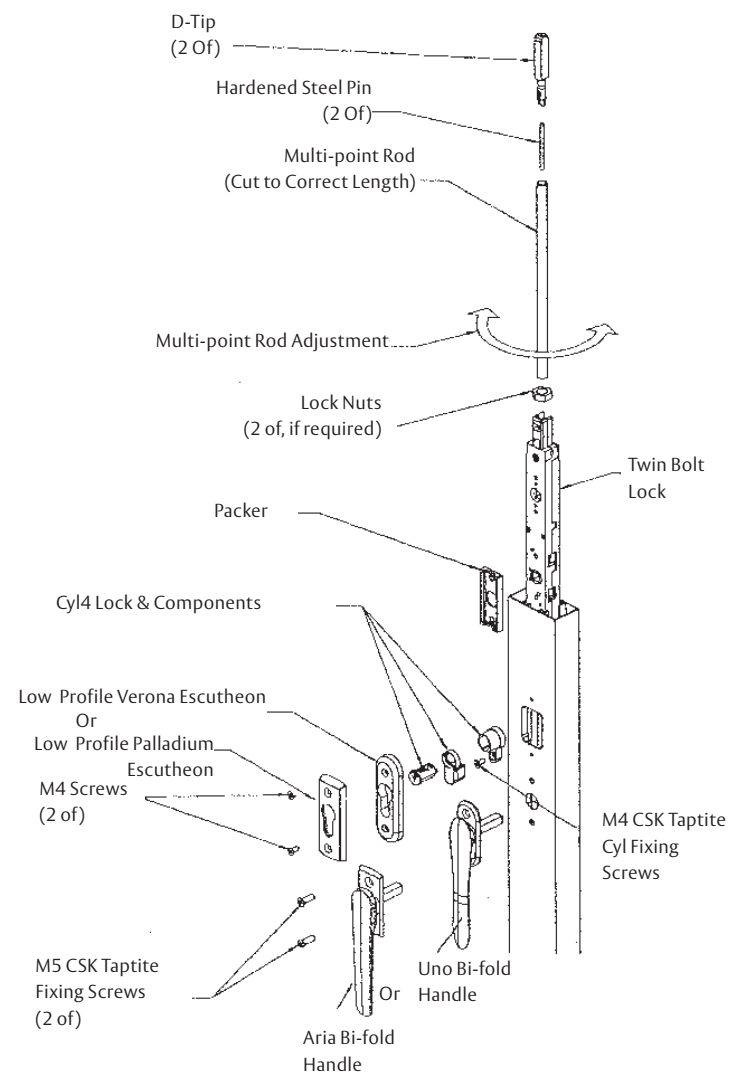
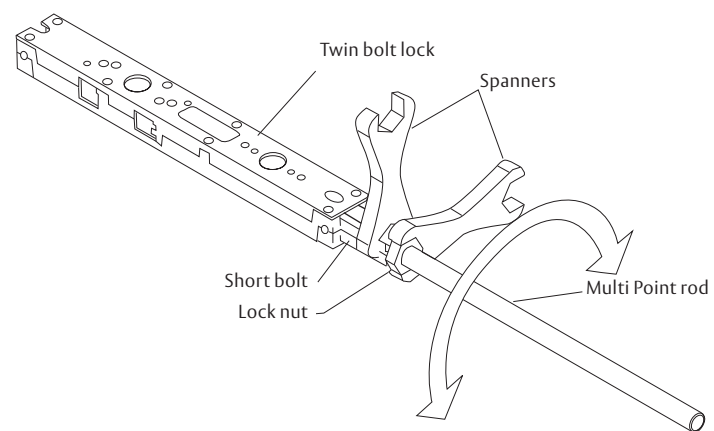

Fig 5. Rod Assembly with Lock Nut



Screw Length Formula

The length of the M5 fixing screws is critical to the performance of the lock.

If the screw is too short the lock will not be held correctly.
If the screw is too long the lock may bind and not operate.

Screw Length = $E + X + P + (4.5 \pm 0.5)$ mm – refer opposite

Figure 6. Screw Length Formula

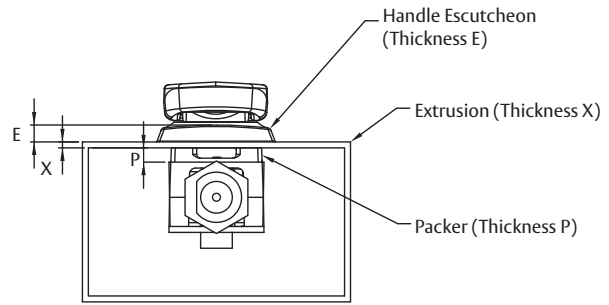

Screw and Packer Selection Guide

This guide shows the M5 screws required for fixing the lock and the M4 screws for fixing the locking cylinder (if locking version), and the packers that should be used in each situation. Note: The screws required for the composite sections are available under separate part numbers.

Sections	Non Locking - Use:	Locking with Low Profile Lock Escutcheon - Use
Aluminium 35mm and larger internal extrusion width	<ul style="list-style-type: none"> • M5 x 26mm Screws • 14.8mm Lock Packer 	<ul style="list-style-type: none"> • M5 x 26mm Screws • M4 x 10mm Screw • 14.8mm Lock Packer
Aluminium 35mm and smaller internal extrusion width For kit numbers P84225 & P84226 only Note: Only for sections with a hinge clearance over 20mm.	<ul style="list-style-type: none"> • M5 x 23mm Screws • 12.5mm Lock Packer <p>Note: 12.5mm packer = 2 x 6.25mm packers</p>	<ul style="list-style-type: none"> • M5 x 23mm Screws • M4 x 10mm Screw • 12.5mm Lock Packer <p>Note: 12.5mm packer = 2 x 6.25mm packers</p>
Composite (17mm thickness of wood and aluminium)	<ul style="list-style-type: none"> • M5 x 26mm Screws 	<ul style="list-style-type: none"> • M5 x 26mm Screws • M4 x 10mm Screw
Composite (19mm thickness of wood and aluminium)	<ul style="list-style-type: none"> • M5 x 32mm Screws • 3.6mm Lock Packer 	<ul style="list-style-type: none"> • M5 x 32mm Screws • 3.6mm Lock Packer • 6mm Cylinder Packer and Adapter • M4 x 16mm Screw

Figure 7. Packer set for aluminium and composite sections

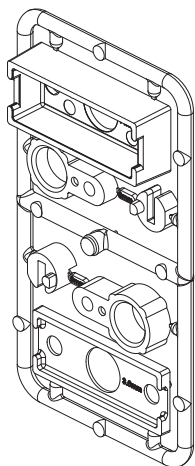

Figure 8. Packer set supplied for kits P84225 and P84226 only

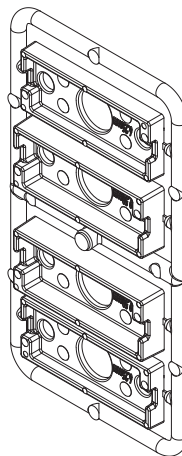
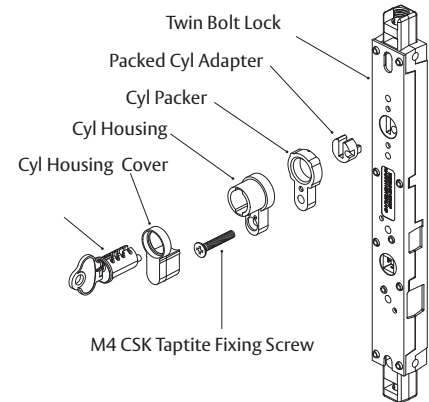

Figure 9. Packing system for locking cylinder



Cylinder Packing

In the situation where the lock is assembled into composite (wood and aluminium) sections, the locking cylinder assembly may require packing to ensure it sits proud of the door, see figure 9.

WARRANTY

ASSA ABLOY New Zealand Ltd ("ASSA ABLOY") guarantees its products against defects in workmanship and materials.

If within 10 years of purchase a product is found to be defective, ASSA ABLOY will supply the same or equivalent product free of charge.

All electrical and electronic components used in ASSA ABLOY's range of products excluding batteries are guaranteed for a period of 12 months from the date of proof of purchase, unless stated otherwise.

ASSA ABLOY assumes no liability under the guarantee for the following:

1. Improper installation or failure to follow fitting instructions.
2. Failure due to improper maintenance.
3. Fair wear and tear.
4. Indirect or consequential loss or damage.
5. Cost of removal and/or replacement.
6. Cost of freight and/or travelling time.
7. Damage to or deterioration of plated finishes (soft finishes). As deterioration is possible under some environmental conditions, these finishes are excluded from this guarantee.
8. Any modification or repairs to a product, as supplied, unless authorised by ASSA ABLOY.
9. Use of replacement parts other than authorised parts.
10. Malfunction or failure of the product due to the use of non-genuine ASSA ABLOY parts.

Nothing in the ASSA ABLOY New Zealand Limited Warranty excludes, restricts or modifies any condition, warranty, right or liability implied or protected by law where to do so would render the Warranty, or any part of it, void.

10
YEARS
WARRANTY

